

Upstairs

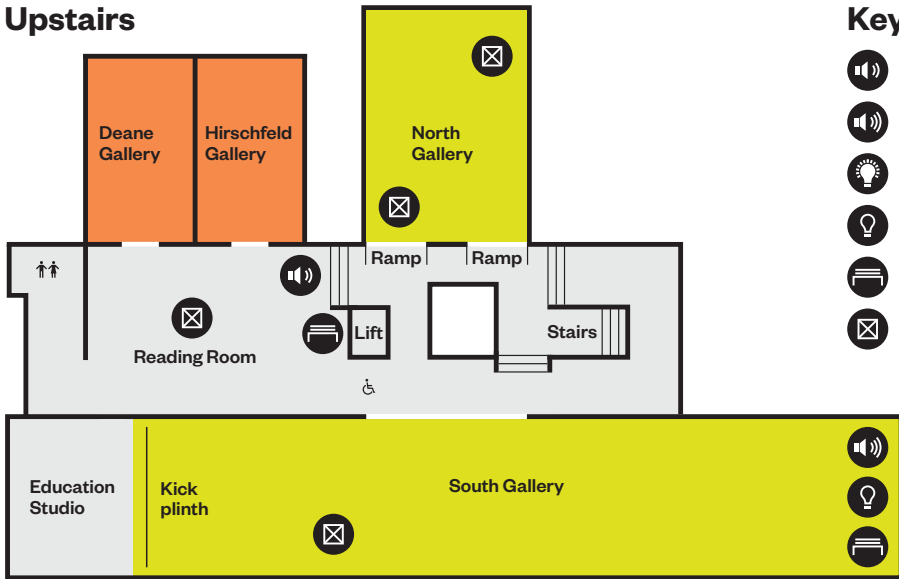

Key

- Sound
- Loud sound
- Bright light
- Low light
- Seating
- Floor based work

Upstairs

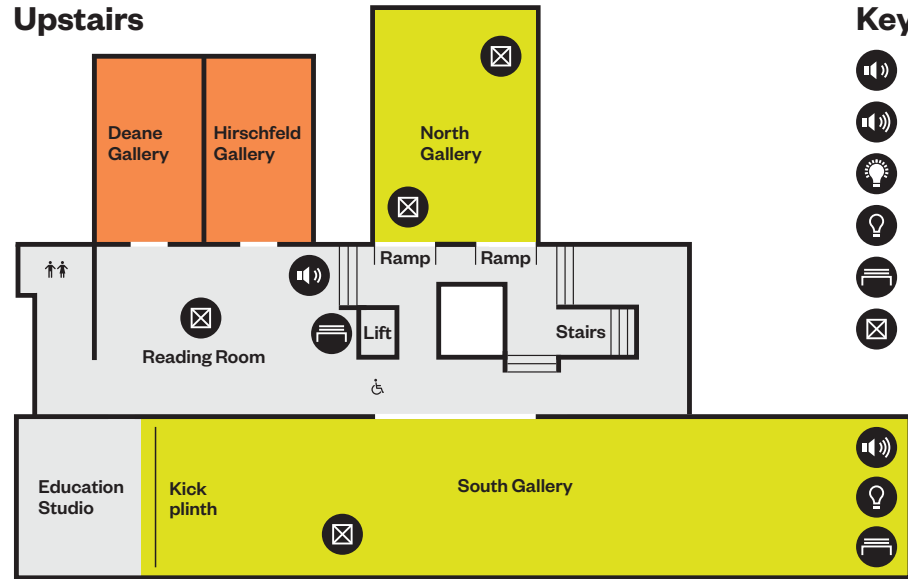

Key

- Sound
- Loud sound
- Bright light
- Low light
- Seating
- Floor based work

Ground Floor

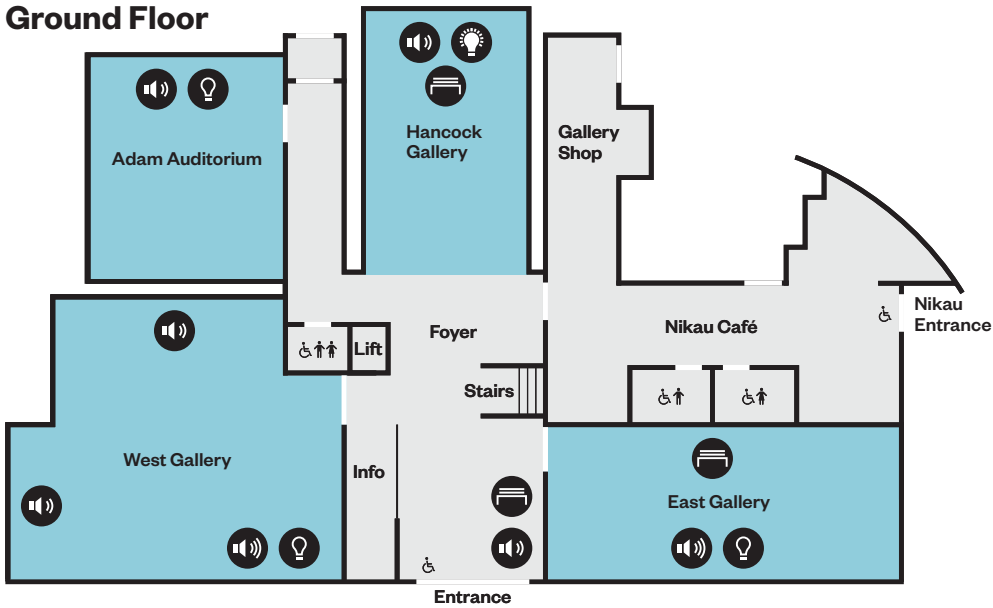

Ground Floor

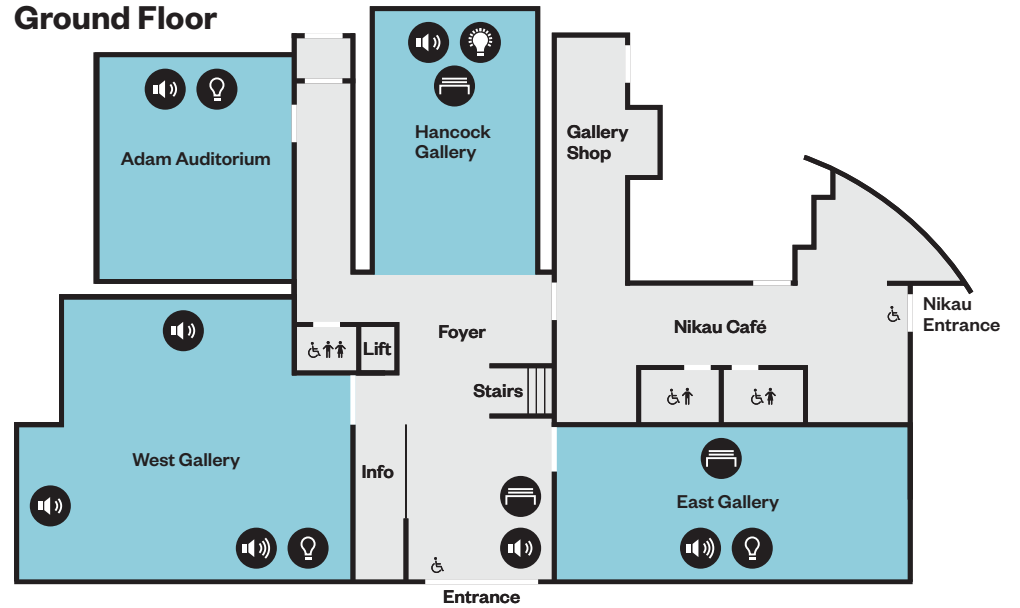

City Gallery Wellington
Te Whare Toi

Ground Floor

Terminal
East and West Galleries, Adam Auditorium, Hancock Gallery

Upstairs

Containing Multitudes
South and North Galleries

The Algorithmic Impulse
Deane and Hirschfeld Galleries

City Gallery Wellington
Te Whare Toi

Ground Floor

Terminal
East and West Galleries, Adam Auditorium, Hancock Gallery

Upstairs

Containing Multitudes
South and North Galleries

The Algorithmic Impulse
Deane and Hirschfeld Galleries

Terminal

Terminal is an exhibition of international art made about the airport, not for it. Its artists variously address the airport as site, form, or symbol—often by subverting its iconography and processes, or tackling its histories and politics.

Zac Langdon-Pole

Containing Multitudes

Zac Langdon-Pole's disorienting, puzzling works prompt us to rethink our relationship to nature, colonial history, and more. Containing Multitudes is the first major New Zealand exhibition by the award-winning Berlin-based expat.

Simon Ingram

The Algorithmic Impulse

Drawing on approaches from artificial life, computer engineering, and robotics, Simon Ingram challenges our idea of 'the artist'. Visit on the weekend and witness his machine make a painting based on a visitor's brainwaves.

Terminal is supported by



Containing Multitudes is supported by



Containing Multitudes and The Algorithmic Impulse is supported by



The safety of our visitors, staff and artworks are our priority.



If you are unwell, please do not enter.



Help protect the artworks. Please do not touch.



Please wear large bags and backpacks on your chest or leave them at the reception desk to avoid damaging artwork.

Any questions, please ask a host.

Opening Hours

Monday – Sunday
11am – 5pm

Part of



Principal Funder

Absolutely Positively
Wellington City Council
Me Heke Ki Pōneke

Terminal

Terminal is an exhibition of international art made about the airport, not for it. Its artists variously address the airport as site, form, or symbol—often by subverting its iconography and processes, or tackling its histories and politics.

Zac Langdon-Pole

Containing Multitudes

Zac Langdon-Pole's disorienting, puzzling works prompt us to rethink our relationship to nature, colonial history, and more. Containing Multitudes is the first major New Zealand exhibition by the award-winning Berlin-based expat.

Simon Ingram

The Algorithmic Impulse

Drawing on approaches from artificial life, computer engineering, and robotics, Simon Ingram challenges our idea of 'the artist'. Visit on the weekend and witness his machine make a painting based on a visitor's brainwaves.

Terminal is supported by



Containing Multitudes is supported by



Containing Multitudes and The Algorithmic Impulse is supported by



The safety of our visitors, staff and artworks are our priority.



If you are unwell, please do not enter.



Help protect the artworks. Please do not touch.



Please wear large bags and backpacks on your chest or leave them at the reception desk to avoid damaging artwork.

Any questions, please ask a host.

Opening Hours

Monday – Sunday
11am – 5pm

Part of



Principal Funder

Absolutely Positively
Wellington City Council
Me Heke Ki Pōneke